

ÜRÜN MONTAJ KLAVUZU

KEOPS GENÇ ODASI KOMODİN

**SATIŞ SONRASI HİZMET
DESTEK WHATSAPP HATTI**



MONTAJ HAZIRLIK: Tüm paketleri dikkatli bir şekilde açınız. Ürün parçalarını şekil ve boyutlarına göre sınıflandırınız.

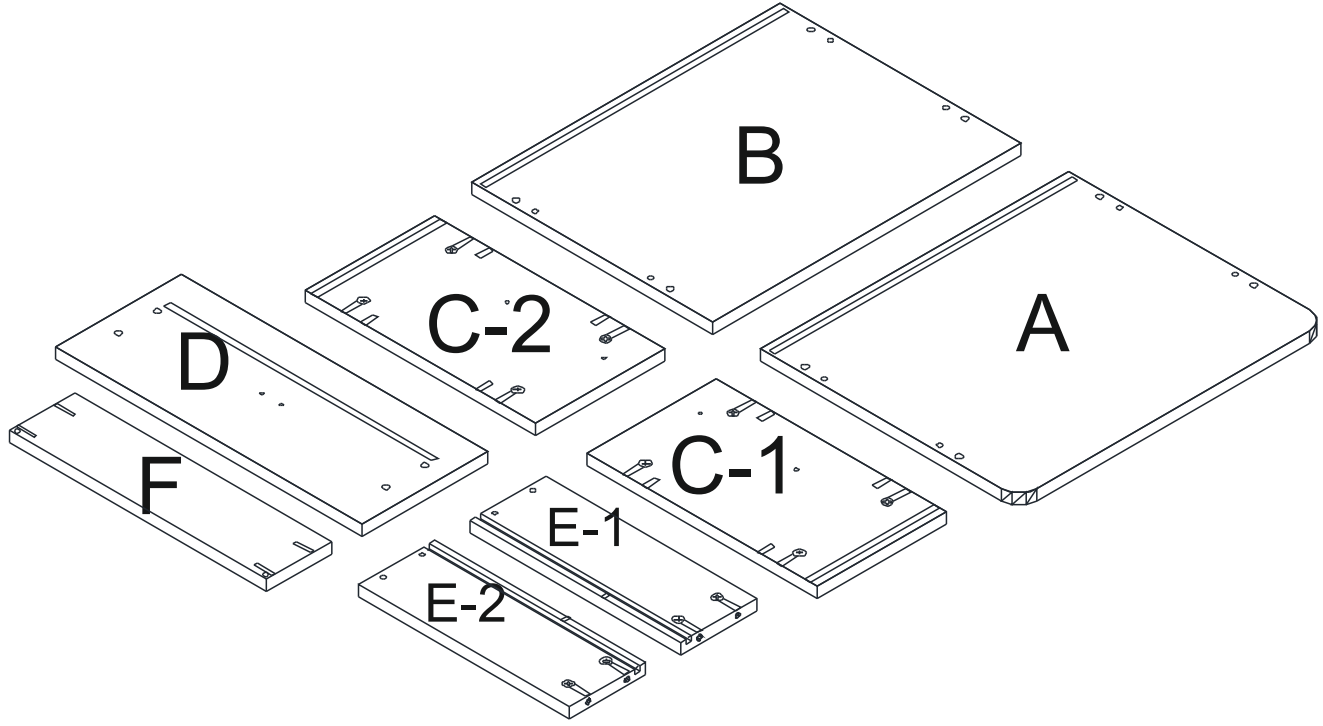

MONTAJ İÇİN GEREKLİ ALET ÖNERİLERİ: Şarjlı matkap, Yıldız başlı tornavida, Çekiç

- A: ÜST TABLA**
- B: ALT TABLA**
- C: SAĞ-SOL YAN TABLA**
- D: ÇEKMECE ÖN YÜZ**
- E: ÇEKMECE YANLAR**
- F: ÇEKMECE ARKA**

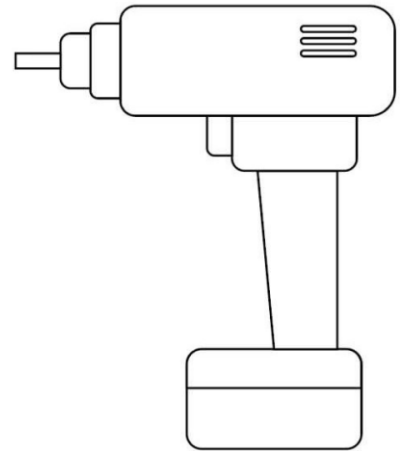
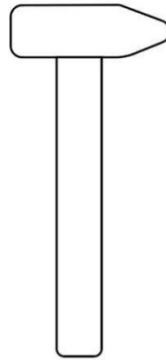

MONTAJ HAZIRLIK: MALZEME POŞET İÇERİĞİ

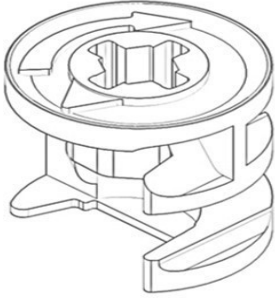

V01

12 ADET MİNİFİX
GÖVDE

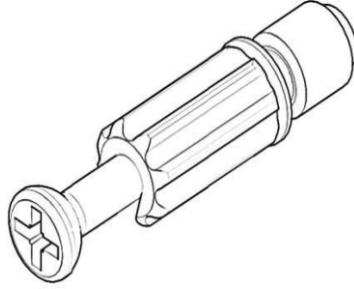

V02

12 ADET MİNİFİX
MİL

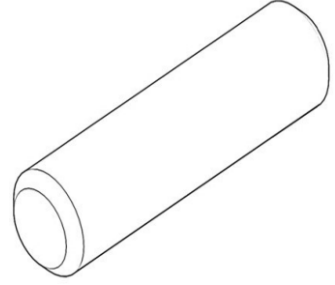

V03

8 ADET PLASTİK
SİYAH KAVELA

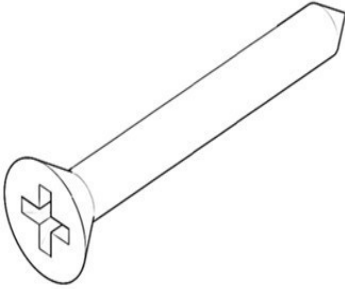

V04

4 ADET
KABİN VİDASI

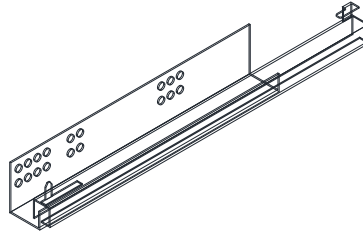

V05

1 TK
35 CM FRENLİ RAY

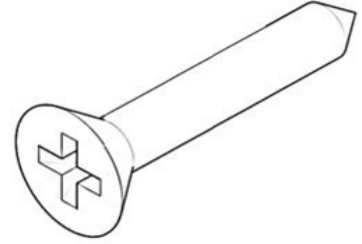

V06

5 ADET
3,5*18 VİDA

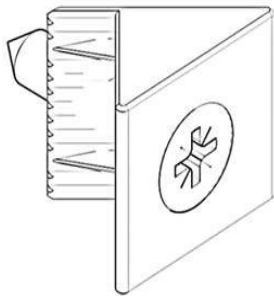

V07

4 ADET
ARKALIK SIKIŞTIRMA

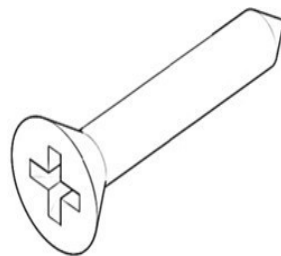

V08

6 ADET
3,5*25 ARKALIK VİDASI

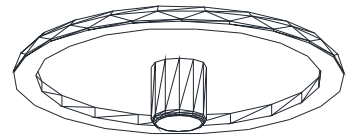

V09

12 ADET
MİNİFİX TIPASI

MONTAJ HAZIRLIK: MALZEME POŞET İÇERİĞİ

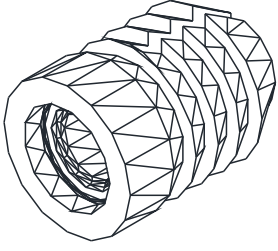

V10

8 ADET
10X10 ŞERİT DUBEL

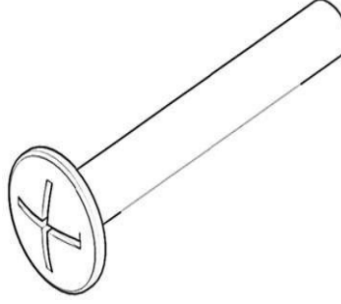

V11

8 ADET
6x25 YSB VİDA

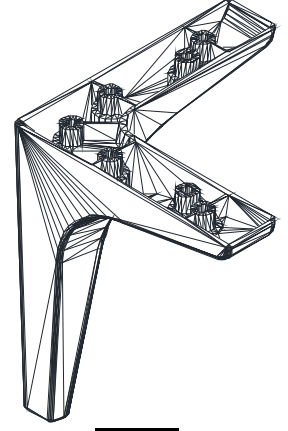

V12

4 ADET
19 CM MODA AYAK

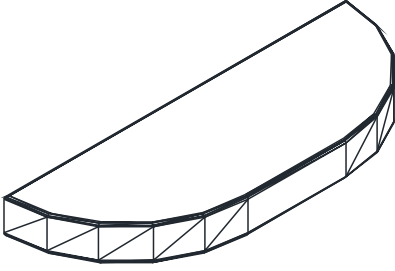

V13

1 ADET
ETİR SİYAH KULP

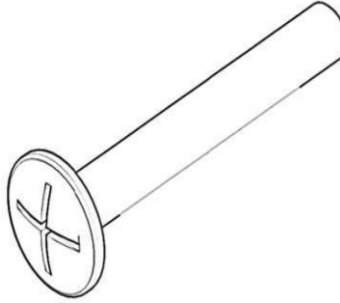

V14

2 ADET
4X22 KULP VİDASI

MONTAJ AŞAMALARI - 1

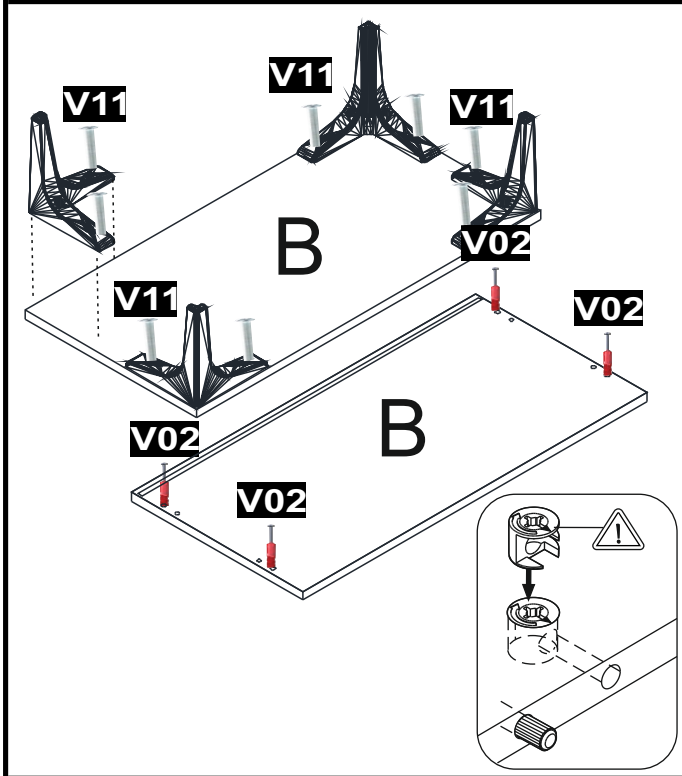

B PARÇASINDA (ALT TABLA) BULUNAN DELİKLERE ŞEKİLDE GÖRÜLDÜĞÜ GİBİ **V02**, **V11** KODLU MALZEMELERİ TAKINIZ.

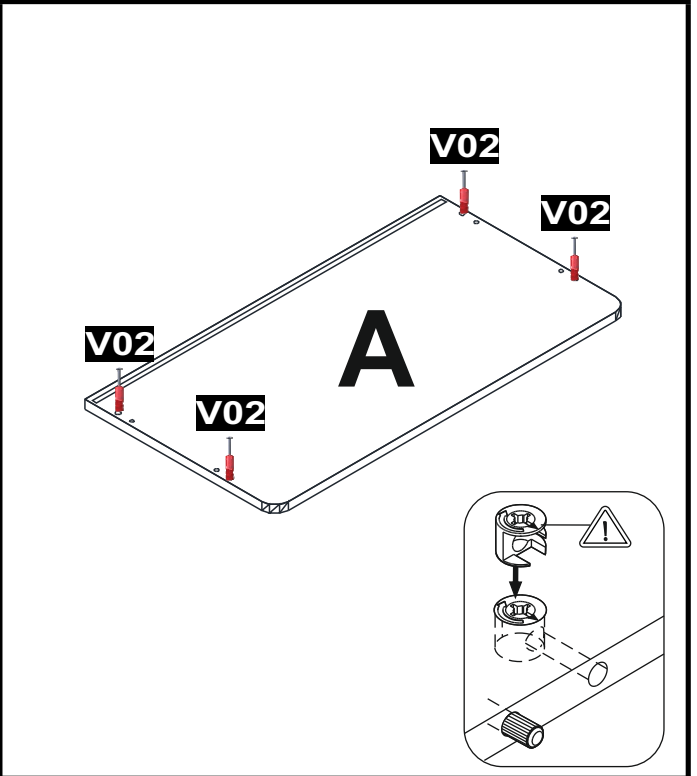

A PARÇASINDA (ÜST TABLA) BULUNAN DELİKLERE ŞEKİLDE GÖRÜLDÜĞÜ GİBİ **V01** - **V02** KODLU MALZEMELERİ TAKINIZ.

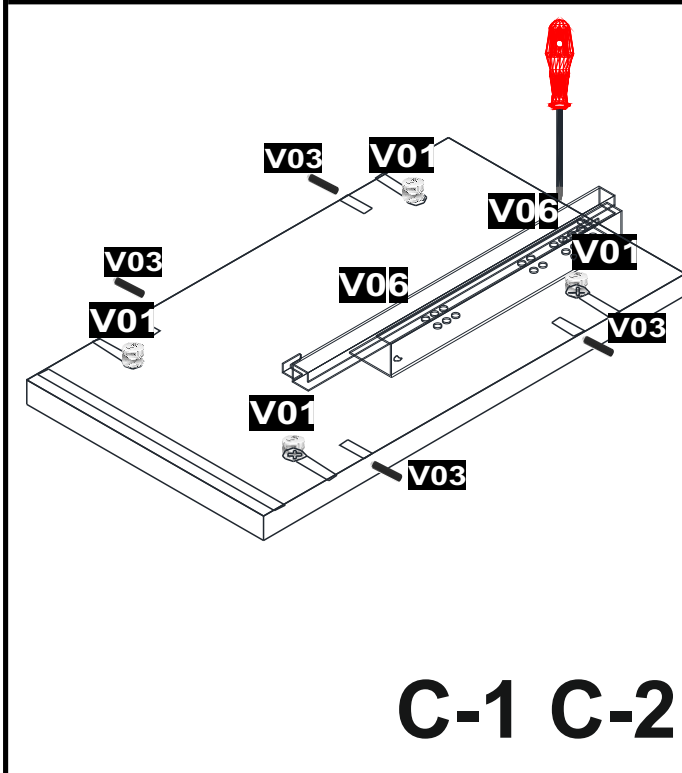

C-1 C-2

C-1 VE **C-2** PARÇALARI (SAĞ-SOL YAN TABLALAR) ÜZERİNDE BULUNAN DELİKLERE **V01** VE **V02** KODLU MALZEMELERİ TAKINIZ. ARDINDAN YAN TABLA ÜZERİNDE BULUNAN VİDALERDEN **V06** VİDALAR İLE RAYLARI BAĞLAYINIZ.

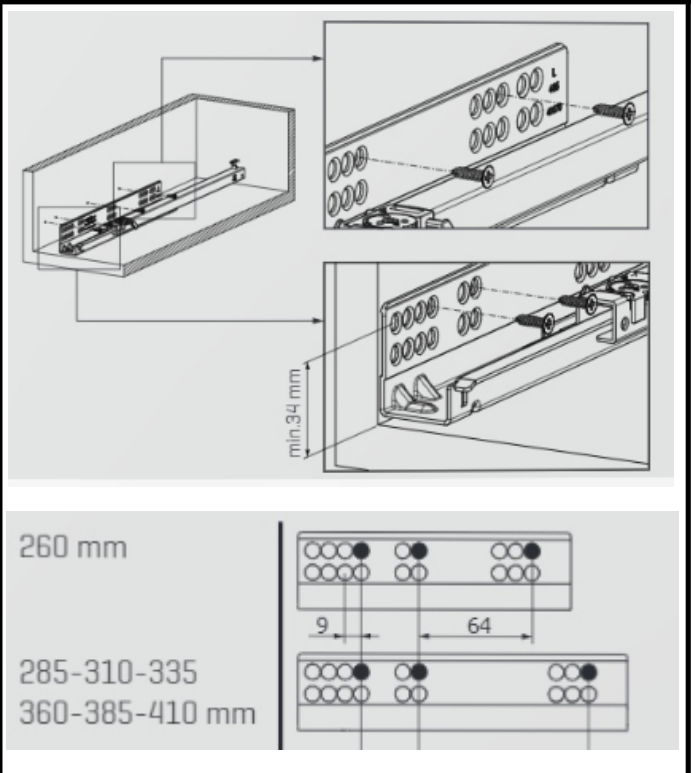

260 mm

285-310-335
360-385-410 mm



V05 KODLU MALZEME (FRENLİ RAY) BAĞLANTI KLAVUZU.

MONTAJ AŞAMALARI - 2

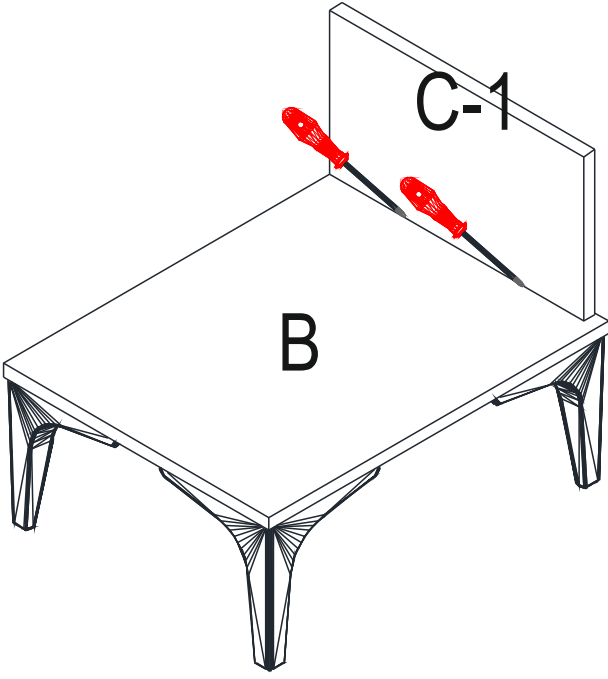

1 AŞAMA ŞEKİLDE GÖRÜLDÜĞÜ GİBİ **B VE C-1** MODÜL SİRALAMASI İLE BAŞLAYINIZ.

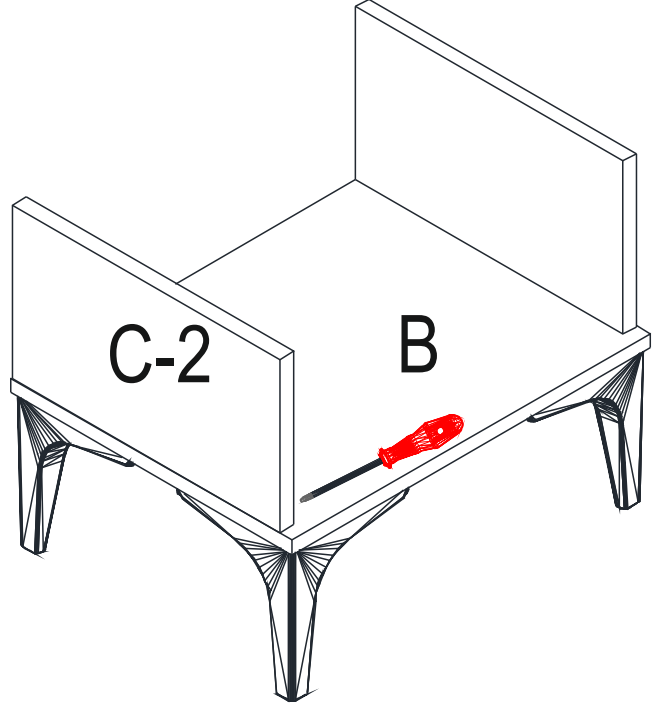

2 AŞAMA ŞEKİLDE GÖRÜLDÜĞÜ GİBİ **C-2** MODÜL SİRALAMASI İLE DEVAM EDİNİZ.

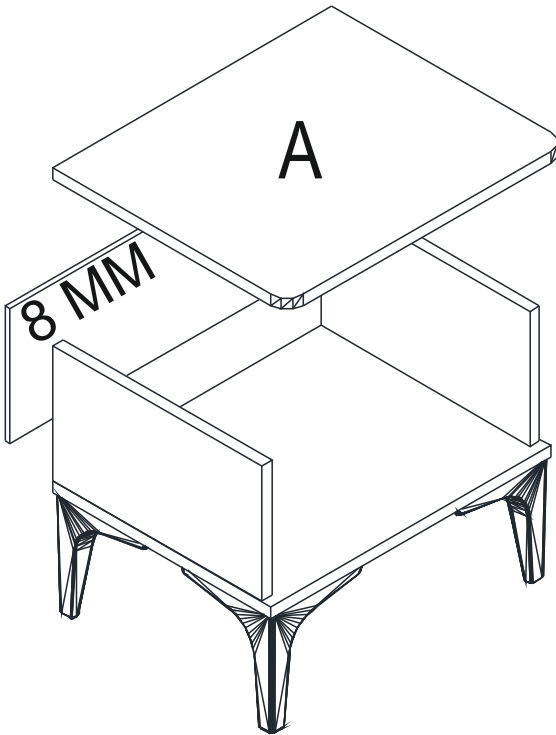

3 AŞAMA İSE ÖNCE 8 MM ARKALIKLARI TAKINIZ DAHA SONRA **A** KODLU ÜSTABLAYI TAKINIZ.

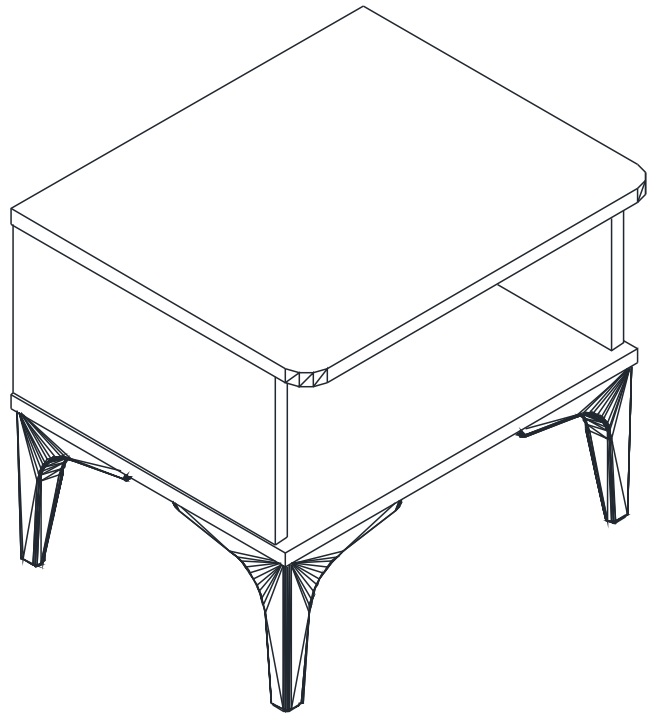

KOMODİN DIŞ AKSAM MONTAJLANMIŞ SON HALİ

MONTAJ AŞAMALARI - 3

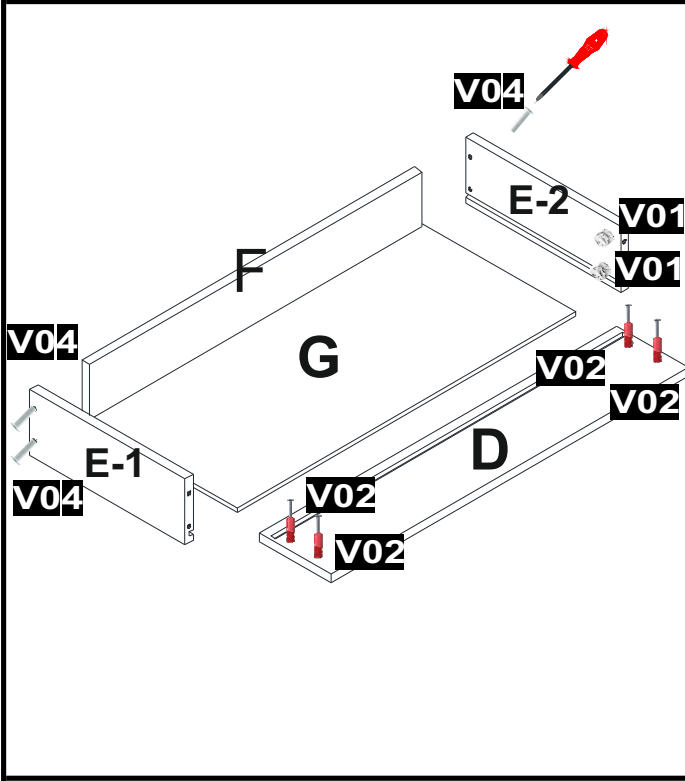

ŞEKİLDE GÖRÜLDÜĞÜ GİBİ **D** PARÇASINA **V02** KODLU MALZEMEYİ TAKINIZ. ARDINDAN **E-1 VE E-2** PARÇALARINI **D** PARÇASINA TAKINIZ. DAHA SONRA KANALLARDAN **G** PARÇASINI GEÇİRİNİZ. SON OLARAK **F** PARÇASINI **V04** KODLU MALZEMELER İLE BİRLEŞTİRİNİZ.

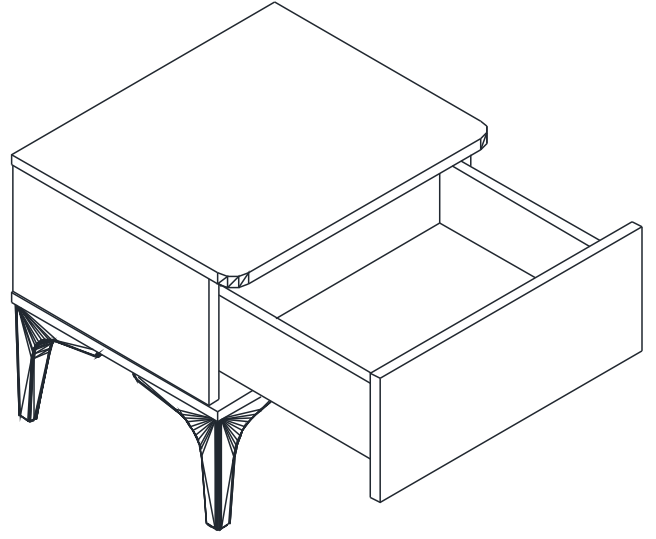

. ÇEKMECE KUTUSU OLUŞTURULDUKTAN SONRA RAY PİMLERİ ALT GÖRSELDE 1. ŞEKİLDE GÖSTERİLEN DELİKLERE DENK GELECEK ŞEKİLDE 2. RESİM TUTUŞ POZİSYONUNDA RAYLARA YERLEŞTİRİNİZ VE ALT KISIMDAKİ PİMLERİ KİLİTLEYİNİZ.

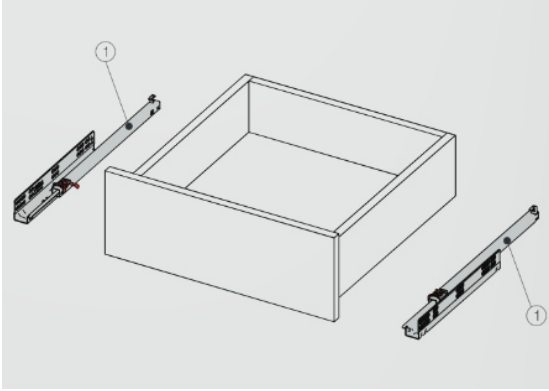
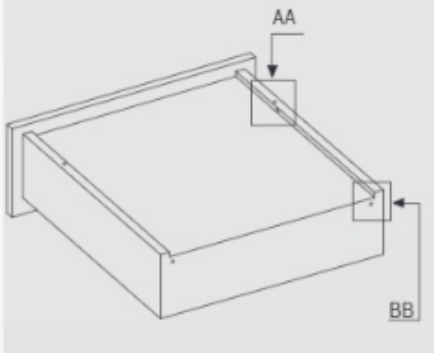

. ÇEKMECE KUTULARI OLUŞTURULDUKTAN SONRA RAY PİMLERİ 1. ŞEKİLDE GÖSTERİLEN DELİKLERE DENK GELECEK ŞEKİLDE 2. RESİM TUTUŞ POZİSYONUNDA RAYLARA YERLEŞTİRİNİZ VE ALT KISIMDAKİ PİMLERİ KİLİTLEYİNİZ.

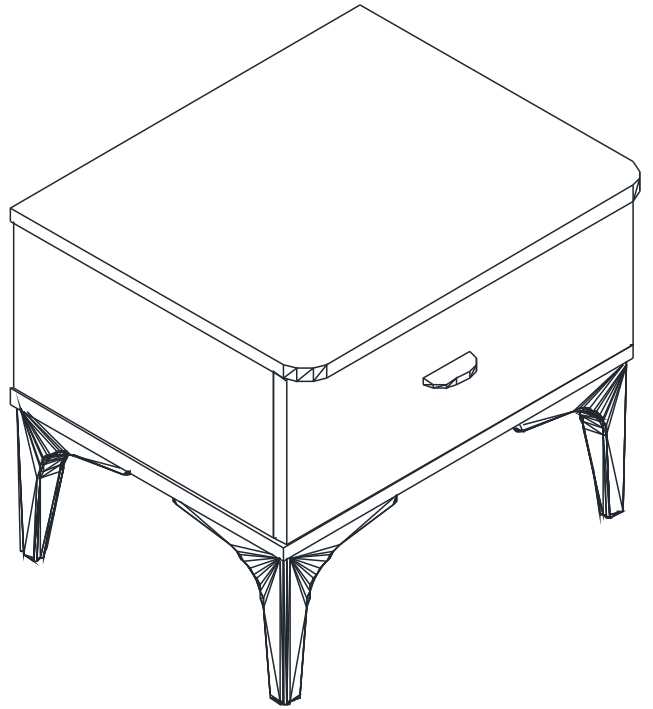

KOMODİN MONTAJI BİTİRİLMİŞ GÖRSELİ.