

ÜRÜN MONTAJ KLAVUZU

KOLEZYUM GENÇ ODASI ŞİFONYER

**SATIŞ SONRASI HİZMET
DESTEK WHATSAPP HATTI**



MONTAJ HAZIRLIK: Tüm paketleri dikkatli bir şekilde açınız. Ürün parçalarını şekil ve boyutlarına göre sınıflandırınız.

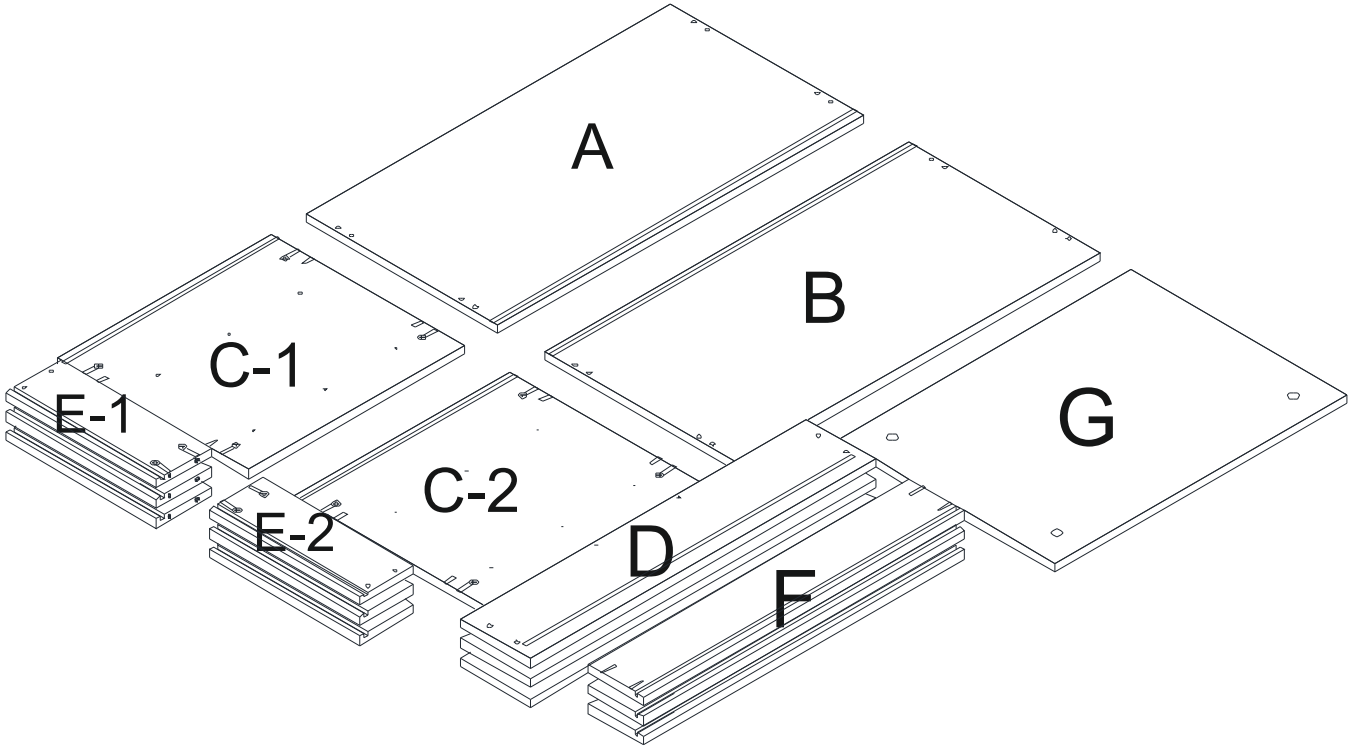

MONTAJ İÇİN GEREKLİ ALET ÖNERİLERİ: Şarjlı matkap, Yıldız başlı tornavida, Çekiç

- A: ÜST TABLA**
- B: ALT TABLA**
- C: SAĞ-SOL YAN TABLA**
- D: ÇEKMECE ÖN**
- E: ÇEKMECE YANLAR**
- F: ÇEKMECE ARKA**
- G: AYNA PANEL**

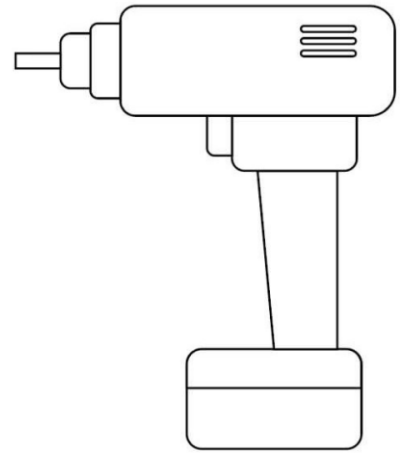
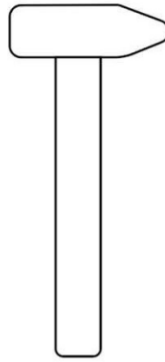

MONTAJ HAZIRLIK: MALZEME POŞET İÇERİĞİ

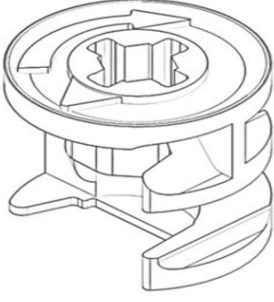

V01

20 ADET MİNİFİX
GÖVDE

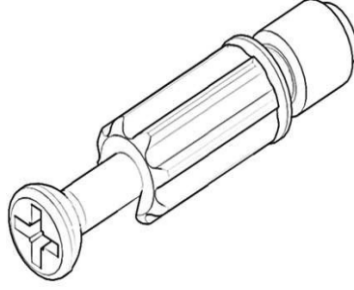

V02

20 ADET MİNİFİX
MİL

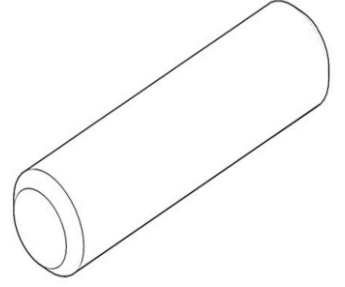

V03

14 ADET PLASTİK
SİYAH KAVELA

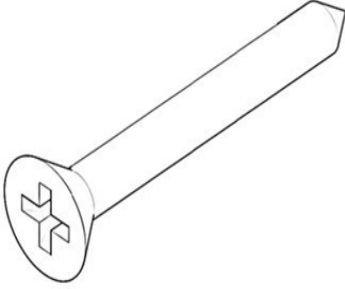

V04

12 ADET
KABİN VİDASI

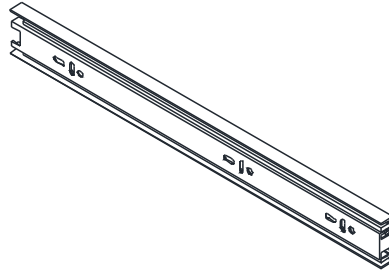

V05

3 TK
35 CM TELESKOBİK RAY

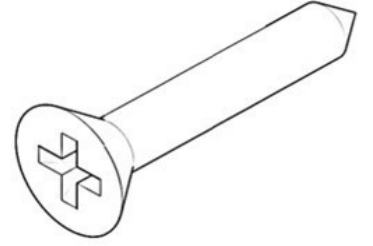

V06

24 ADET
3,5*18 VİDA

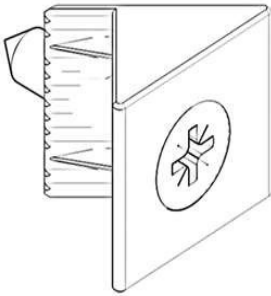

V07

6 ADET
ARKALIK SIKIŞTIRMA

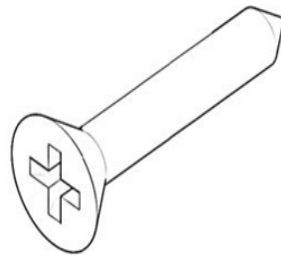

V08

6 ADET
3,5*25 ARKALIK VİDASI

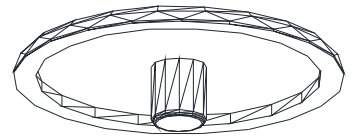

V09

20 ADET
MİNİFİX TIPASI

MONTAJ HAZIRLIK: MALZEME POŞET İÇERİĞİ

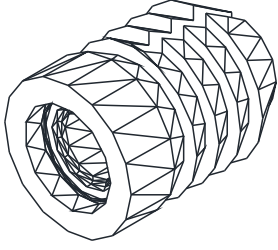

V10

8 ADET
10X10 DUBEL

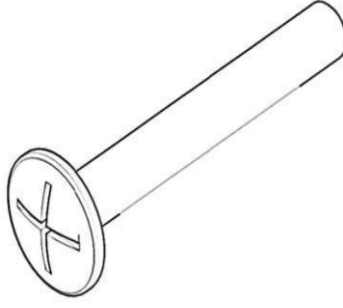

V11

8 ADET
M6X25 YSB VİDA

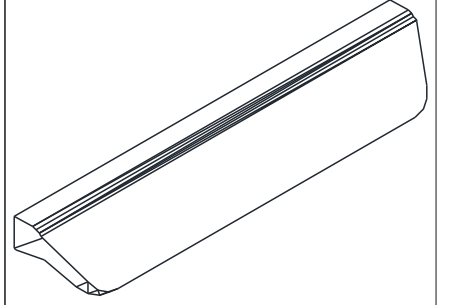

V12

3 ADET
POLO BÜYÜK KULP

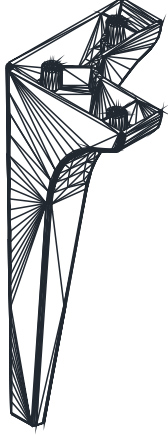

V13

4 ADET
MODA SİYAH AYAK

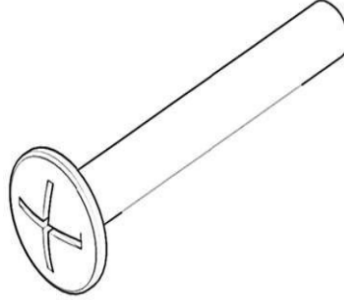

V14

6 ADET
4X22 KULP VİDASI

V15

V16

V17

V18

MONTAJ AŞAMALARI - 1

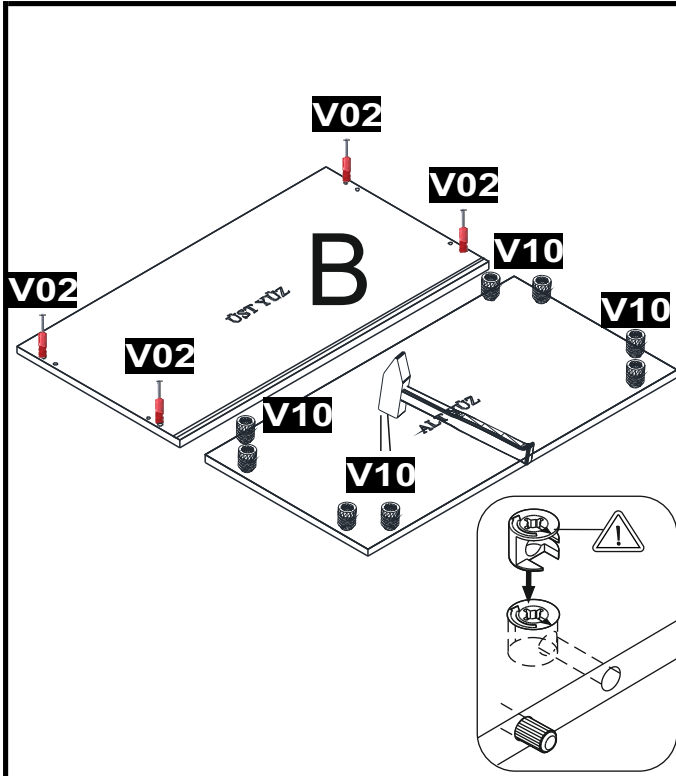

B PARÇASINDA (ALT TABLA) BULUNAN DELİKLERE ŞEKİLDE GÖRÜLDÜĞÜ GİBİ **V02** ALT YÜZÜNE İSE **V10** KODLU DUBEL ÇAKILACAK..

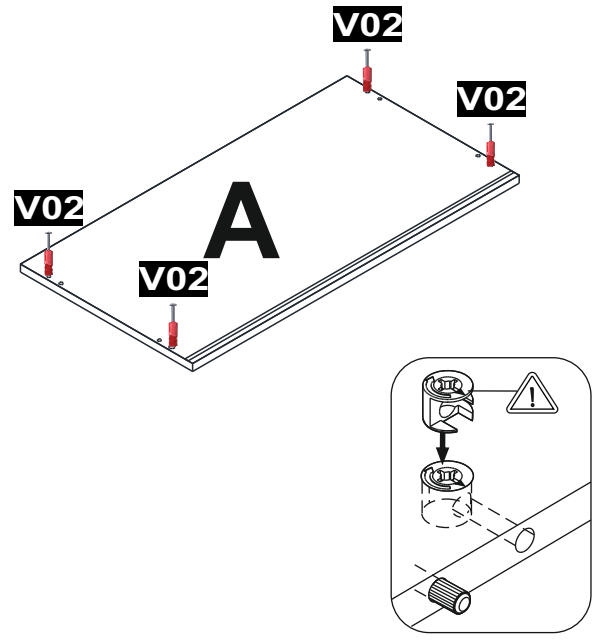

A PARÇASINDA (ÜST TABLA) BULUNAN DELİKLERE ŞEKİLDE GÖRÜLDÜĞÜ GİBİ **V02** KODLU MALZEMELERİ TAKINIZ.

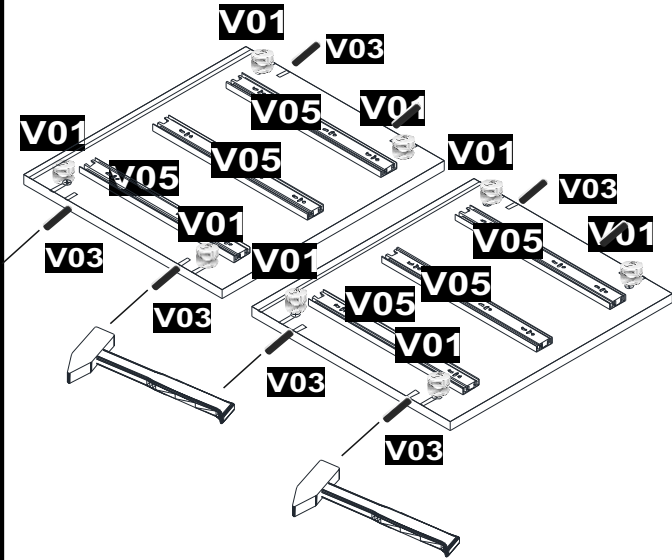

C-1 C-2

C-1 VE **C-2** PARÇALARI (SAĞ-SOL YAN TABLALAR) ÜZERİNDE BULUNAN DELİKLERE **V02** KODLU MALZEMELERİ TAKINIZ. ARDINDAN YAN TABLA ÜZERİNDE BULUNAN VİDA İZLERİNDEN **V06** VİDALAR İLE RAYLARI BAĞLAYINIZ.

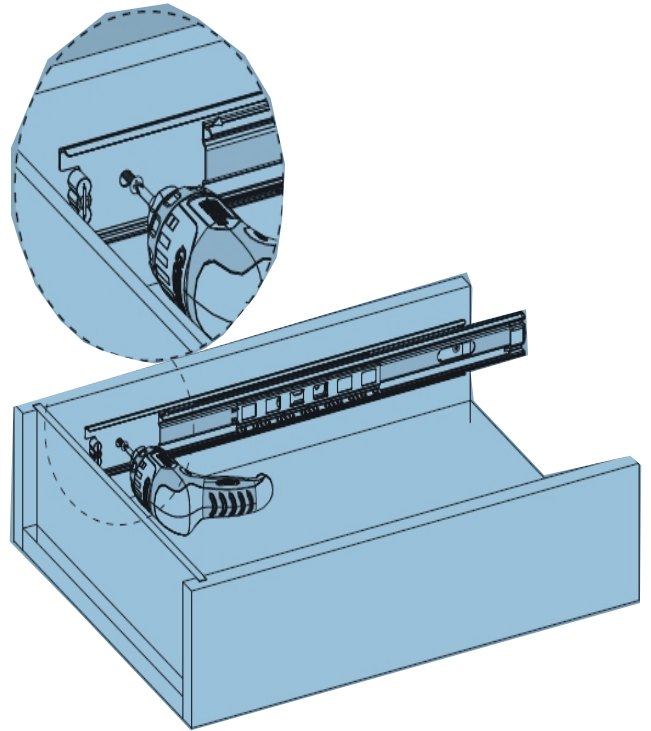

MODÜL YAN ÇEKMECE BAĞLAMA ŞEKLİ. **V06** KODLU MALZEME KULLANINIZ **3,5X18 VİDA**

MONTAJ AŞAMALARI - 2

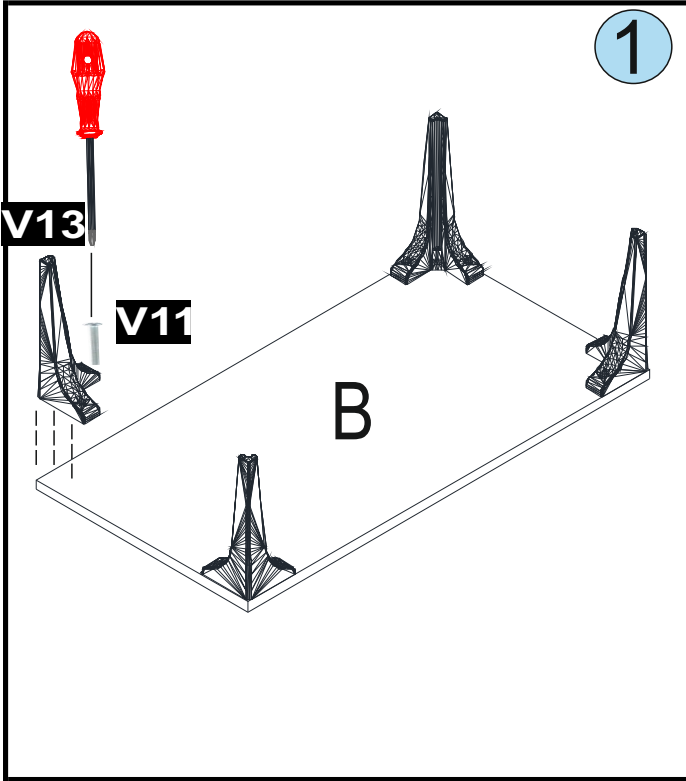

MONTAJA BAŞLAMADAN ÖNCE **B** KODLU (ALT TABLAYI) ALT YÜZ KISMINDA BULUNANAN PLASTİK AYAKLARI METRİK **V11** KOD İLE TORNAVİDA YARDIMI İLE BAĞLAYINIZ.

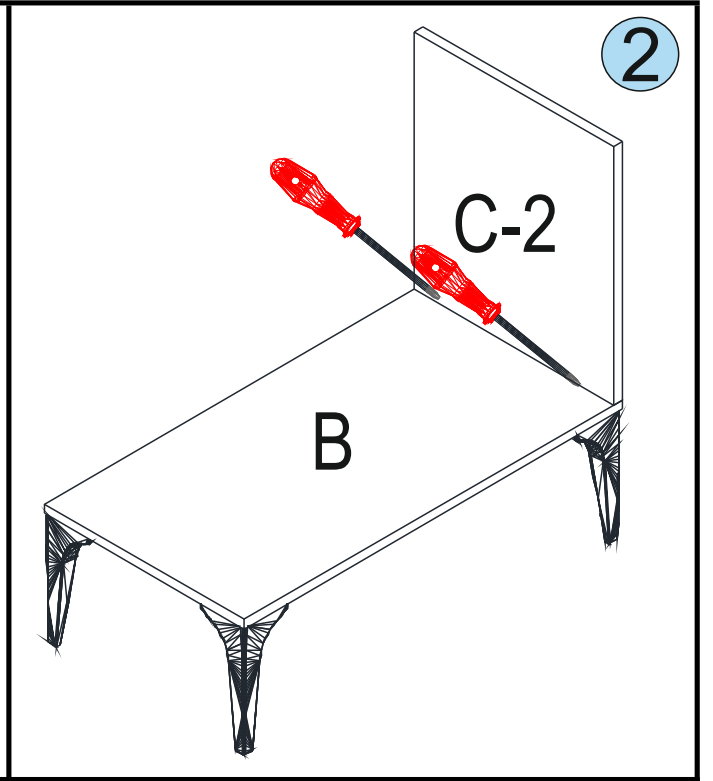

İLK AŞAMADA **B** PARÇASININ (ALT TABLADAN) BAŞLAYARAK ÜZERİNE **C-2** PARÇASINI (SAĞ YAN TABLA) KOYUNUZ TORNAVİDA YARDIMI İLE BAĞLAYINIZ.

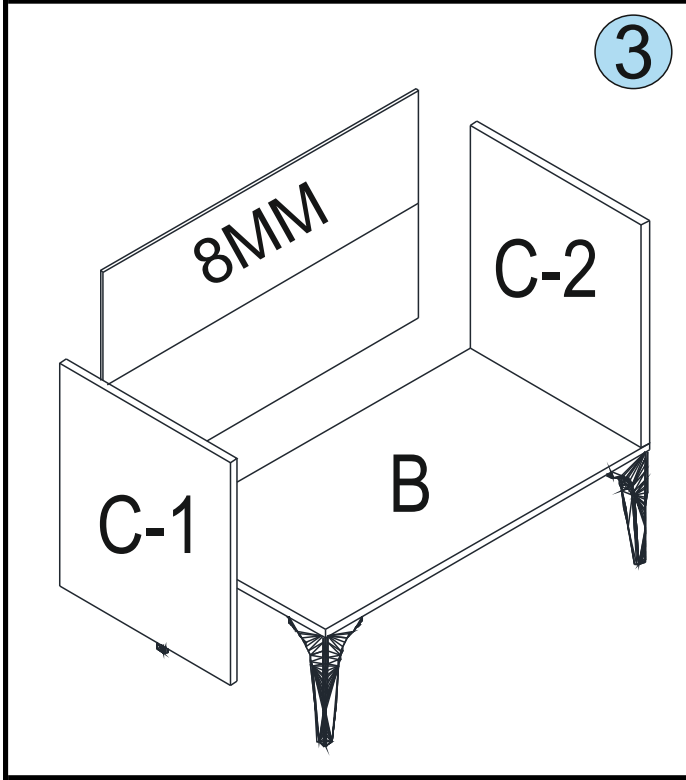

İLK ÖNCE 8MM ARKALIK DAHA SONRA **C-1** KODLU (SOL YANI) TAKINIZ

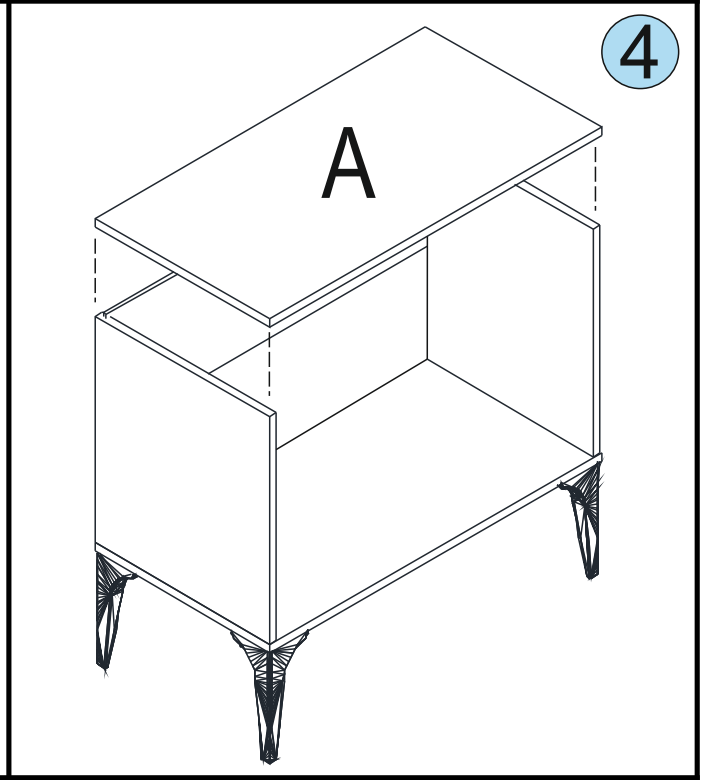

ŞİFONYER MONTAJ SON AŞAMA İSE **A** KODLU (ÜST TABLAYI) TAKINIZ

MONTAJ AŞAMALARI - 3

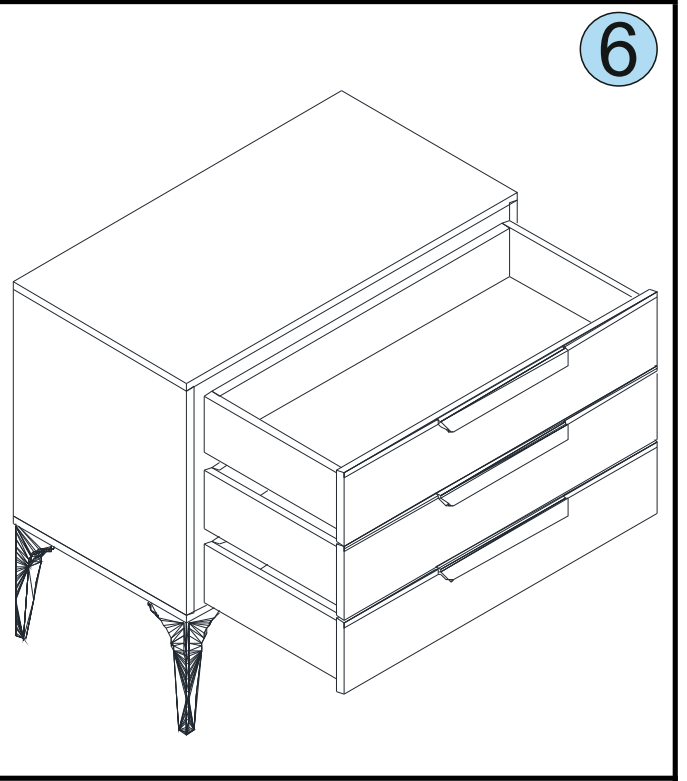
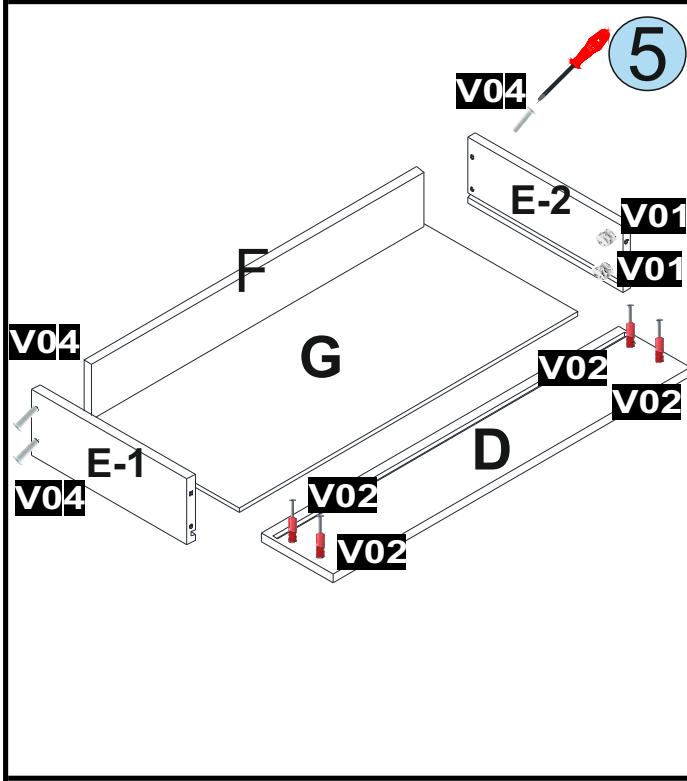

ŞEKİLDE GÖRÜLDÜĞÜ GİBİ **D** PARÇASINA **V02** KODLU MALZEMEYİ TAKINIZ. ARDINDAN **E-1 VE E-2** PARÇALARINI **D** PARÇASINA TAKINIZ. DAHA SONRA KANALLARDAN **G** PARÇASINI GEÇİRİNİZ. SON OLARAK **F** PARÇASINI **V04** KODLU MALZEMELER İLE BİRLEŞTİRİNİZ.

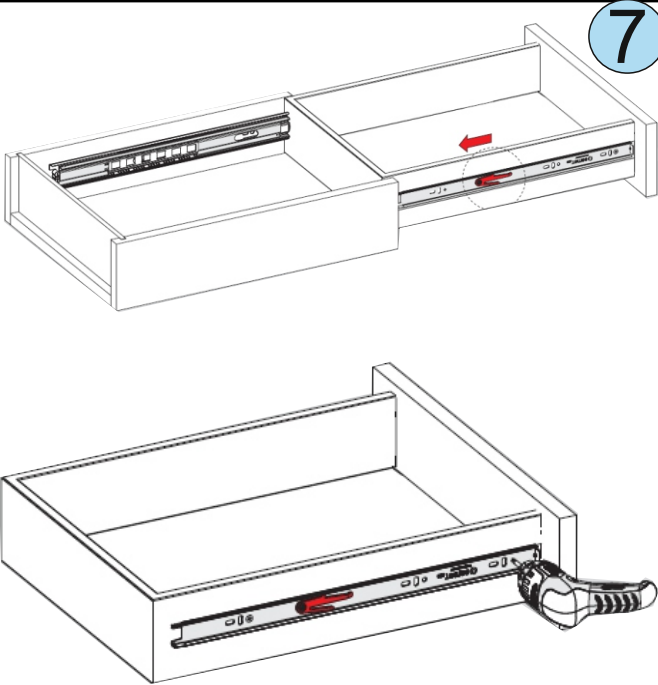

ÇEKMECE YANINA DIŞTAN TAM MERKEZE GELECEK ŞEKİLDE **V06** KODU VİDA YARDIMI İLE BAŞTAN SIFIR OLACAK ŞEKİLDE SIKINIZ

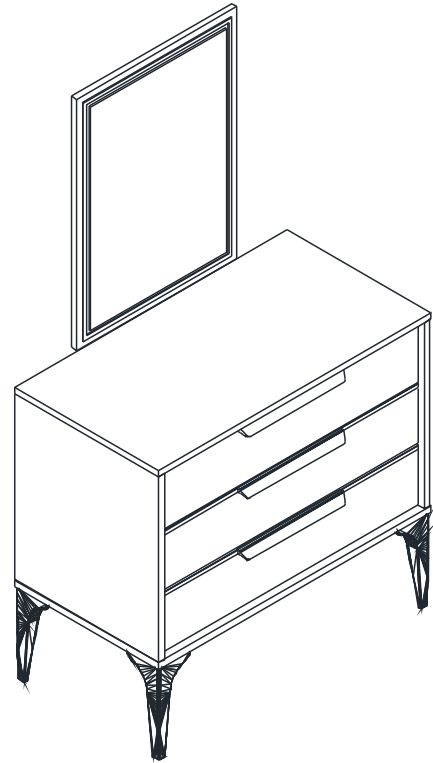

ŞİFONYER MONTAJI BİTİRİLMİŞ GÖRSELİ.